

PVC-U valve BX is a double union ball valve ideal for heavy duty applications, chemical applications and water treatment.

- Full bore ball locked in place on both sides.
- Machined ball to ensure the best sealing.
- Sea y incorporated on the handle.
- PVC-U compound fit for contact with potable water according to European, UK and USA regulations.
- Marine Application approval.
- Compliant with the requirements of Pressure Equipment Directive 2014/68/EU, Annex III, Module A2.

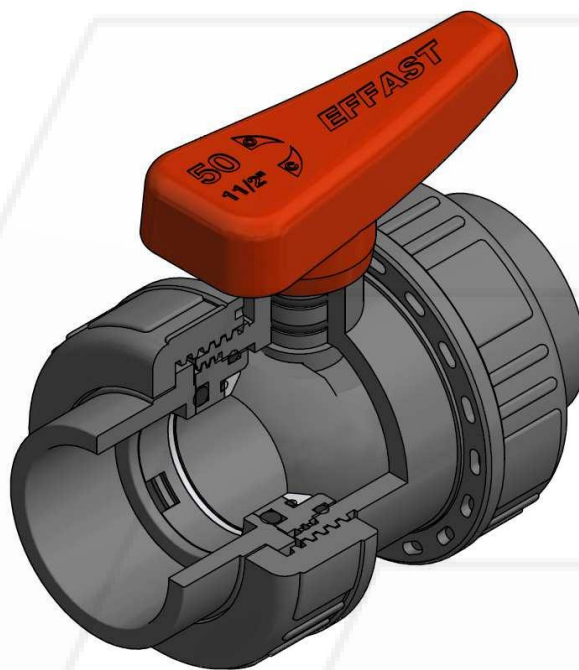

TECHNICAL FEATURES

NOMINAL PRESSURE	PN 16 (20°C)
DIMENSIONS	DN 15 ÷ DN 100 (d.16 ÷ 110 mm – 3/8" ÷ 4")
VALVE MATERIAL	PVC-U
SEALS MATERIAL	O-rings: EPDM or FKM / O-ring: EPDM o FKM Ball seats: PTFE
TEMPERATURE RANGE	0°C ÷ 60°C
COUPLING STANDARDS	Solvent welded sockets: metric, BS Threaded sockets: BSPP EN/ISO/DIN flanges HDPE spigots
CONTROL OPTIONS	Hand-operated



Certifications and approvals: only for items declared on Official Listing or certificates. / Certificazioni: solo per gli articoli dichiarati nelle Official Listing o nei certificati stessi.

Tel: 01626 201092

www.efault.com

EFFAST

quotes@tipes.co.uk

PVC-U Double union ball valves BX

Operating pressure

Maximum operating pressure for PVC-U: according to temperature as shown in graph.

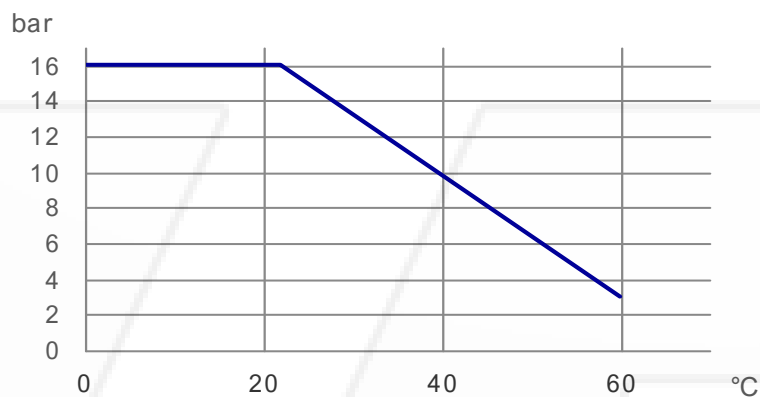

Pressure loss

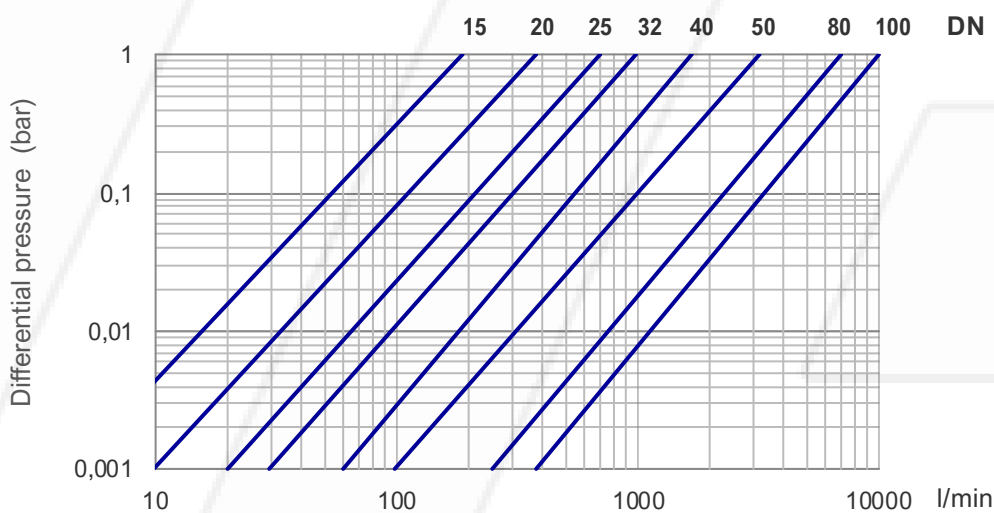

Flow rate coefficient Kv100

At $\Delta p = 1 \text{ bar}$ / Per $\Delta p = 1 \text{ bar}$

DN	DN 15	DN 20	DN 25	DN 32	DN 40	DN 50	DN 80	DN 100
l/min	190	380	700	1000	1700	3200	7000	10000

Torque force at maximum pressure rate

DN	DN 15	DN 20	DN 25	DN 32	DN 40	DN 50	DN 80	DN 100
Nm	1.5	2	3	5	7	10	24	30

Tel: 01626 201092

www.efault.com

EFFAST

PVC-U Double union ball valves BX

Components

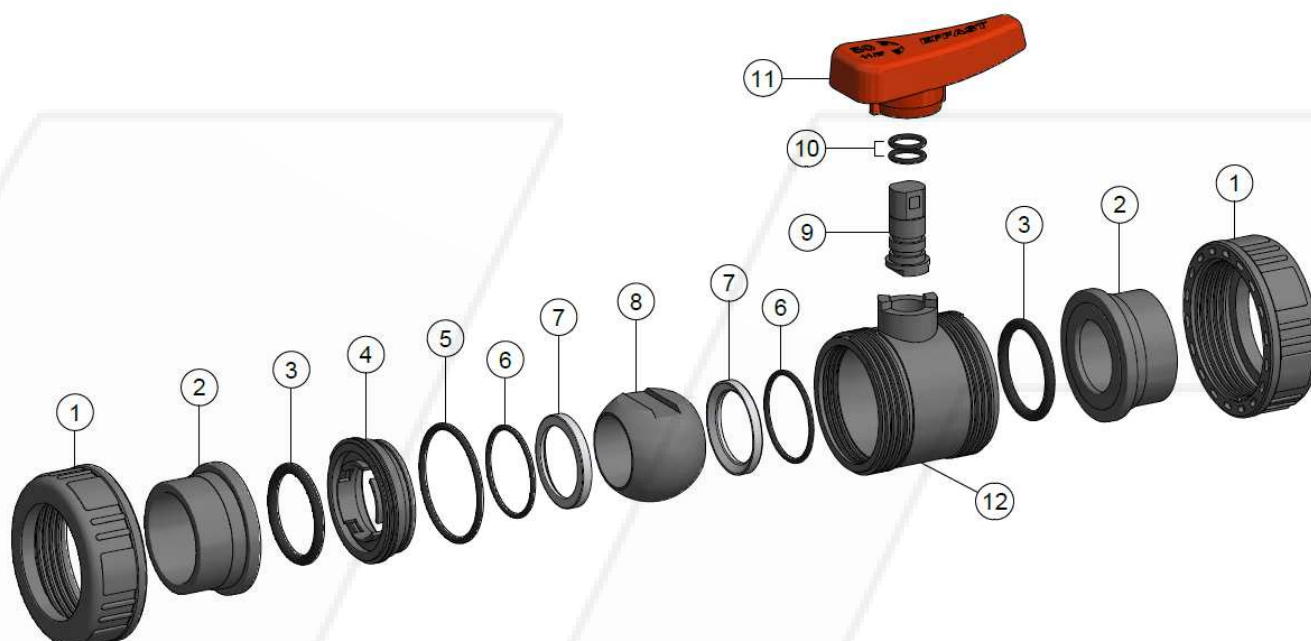

n.	COMPONENT	MATERIAL	Qty
1	Nut / Ghiera	PVC-U	2
2	Socket / Manicotto	PVC-U	2
3	Socket O-ring / O-ring manicotto	EPDM/FKM	2
4	Gasket carrier / Supporto guarnizioni	PVC-U	1
5	Body O-ring / O-ring corpo	EPDM/FKM	1
6	Ball seat O-ring / O-ring tenute	EPDM/FKM	2

n.	COMPONENT	MATERIAL	Qty
7	Ball seat / Tenuta sfera	PTFE	2
8	Ball / Sfera	PVC-U	1
9	Stem / Asta	PVC-U	1
10	Stem O-ring / O-ring asta	EPDM/FKM	2
11	Handle / Maniglia	PVC-U	1
12	Body / Corpo	PVC-U	1

quotes@tipes.co.uk

Tel: 01626 201092

www.efault.com

EFFAST